



26 Frenchs Forest Road Frenchs Forest NSW

3 2 2

Large level block of 755sqm with North facing rear yard and backing onto a fantastic kids play park - with direct access to the property

Double brick construction, 9 foot ceilings, 3 bedrooms plus full bathroom.

Spacious lounge & dining, separate family room plus large eat-in kitchen

Timber floors and slow-combustion fire plus much more

Separate studio offers 2 bedrooms, bathroom, kitchen and living space

Lock-up garage, storeroom, external laundry plus large shed

Enjoy a quality lifestyle close to everything

Walk to Skyline Shops, Organic Markets and City / Chatswood / Manly bus stops

Close to the new Hospital, proposed new town centre, Aquatic Centre, sports fields, schools and beaches

Land Size : 755 sqm

View : <https://www.skylinerealestate.com.au/lease/nsw/northern-beaches/frenchs-forest/residential/house/5824249>



Michelle Smart
02 9452 3444

26 Frenchs Forest Road Frenchs Forest

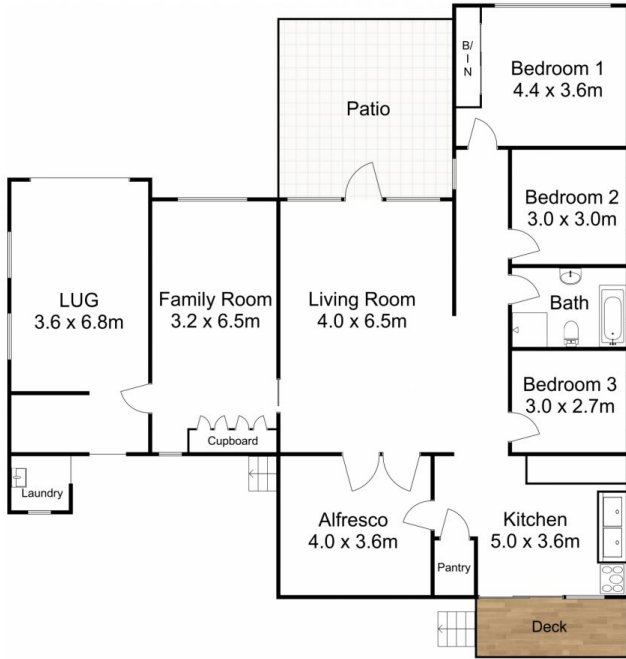

This Floor Plan is generated for indicative purposes only. Information is provided in good faith and from a variety of sources. Dimensions are approximate and although believed to be reliable, its accuracy cannot be guaranteed and persons interested should rely on their own enquiries.