



**79 Lonsdale Avenue Berowra Heights NSW**

3 2 2

Move straight in and enjoy an idyllic and peaceful setting in a desirable cul de sac location, 79 Lonsdale Avenue presents as the ideal first family home or equally suited to downsizers.

This solid brick 3 bed, home is set on a fantastic 577m<sup>2</sup> block with a level rear yard and plenty of grass area that is both private and child friendly where the kids can safely play. Its low maintenance living and still offers great space for the gardening enthusiasts.

The living space is generous with a formal lounge area with gas fireplace, open plan kitchen and family room that flows directly out to the undercover alfresco entertaining area. Perfect for parties and entertaining family and friends.

[For full version visit the website](https://www.skylinerealestate.com.au)

**Type** : House  
**Land Size** : 577.9 sqm  
**View** : <https://www.skylinerealestate.com.au/sale/nsw/hawkesbury/berowra-heights/residential/house/8160054>



**Damien Dwyer**  
02 9452 3444



**Stuart Bath**  
02 9452 3444



The floor plan is not to scale; measurements are indicative and in metres. All features included in this 3D plan are for inspiration purposes only. This is not an exact replica of the property or the position of exterior elements. Plans should not be relied on. Interested parties should make and rely on their own enquiries.

Produced by **DIAKRIT**

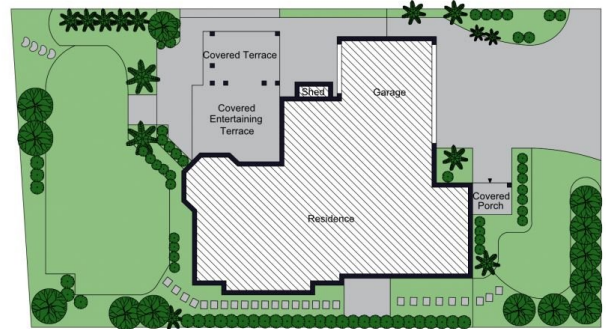

Site Plan

The site plan and floor plan are not to scale; measurements are indicative and in metres. Bushes and trees are placed for illustration purposes. Plans should not be relied on. Interested parties should make and rely on their own enquiries.

Produced by **DIAKRIT**